



# Accuracy International

## **TRIGGER ADJUSTMENT for AW, AX, AT, and AE Rifles.**

## **Copyright**

All rights reserved. No part of this publication may be reproduced, stored in a retrieval system or transmitted in any form or by any means - electronic, photocopying, recording or otherwise - without prior written permission from Accuracy International Limited, Portsmouth, United Kingdom.



# Accuracy International Ltd.

## Customer Communications

Accuracy International welcomes your feedback on our products and service, both positive and negative.

We are able to offer Service / Repair and Spares packages.

Our Sales team is available to discuss how we may be of assistance to you now and in the future.

### UK & Rest Of World

Accuracy International Ltd.  
P.O. Box 81  
Portsmouth  
Hampshire  
PO3 5SJ  
United Kingdom

Tel: +44 (0)23 9267 1225  
Fax: +44 (0)23 9269 1852  
Email: [ai@accuracyinternational.org](mailto:ai@accuracyinternational.org)

### USA Only

Accuracy International North America – Civilian, Law Enforcement & military

Accuracy International North America  
Fredericksburg,  
Virginia,  
USA.

Tel: +1 540 368 3108  
Fax: +1 540 368 3109  
Email: [aina@accuracyinternational.us](mailto:aina@accuracyinternational.us)

## Component Identification

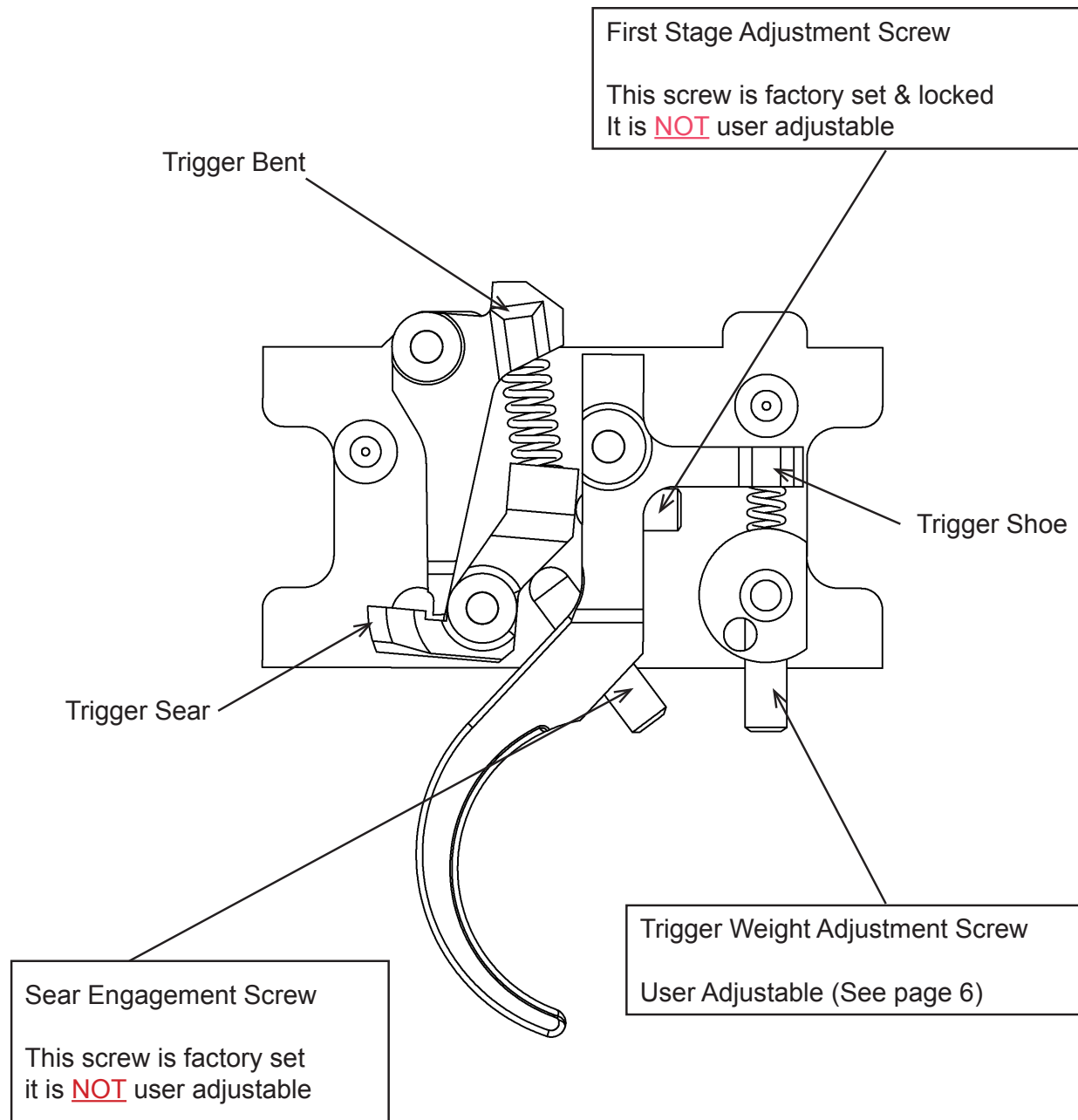

Fig 1

**NOTE:** The triggers fitted to various models of rifles may appear different externally however the internal adjustments and screw positions are identical.

The trigger weight screw referenced above should be adjusted in accordance with this guide only. Triggers must not be adjusted or modified to single stage.

## Safety

This document should be read and fully understood before attempting any adjustment.

### Safe Handling Instructions

When the user is unaware of the weapon status (loaded or unloaded), it should always be assumed that it is loaded.

A weapon that is to be handed over must be presented unloaded, with the bolt open and in the rearward position.



Before handling the rifle or carrying out any procedure described in this document. The user must ensure their own and the safety of others by:  
Standing behind the weapon,  
Ensuring it is pointing in a safe direction,  
Checking it is unloaded and safe to handle.



When operating the bolt, ALWAYS cycle it fully i.e. completely open and close the bolt every time it is manipulated.  
Failure to fully close the bolt every time the bolt is manipulated could result in a live round being left in the chamber, as the extractor does not engage the cartridge unless the bolt is fully closed.



Before using the rifle always check to ensure that:

The serial numbers of the action body, bolt body and shroud body match.

The muzzle brake and suppressor (where fitted) are securely fitted and not clogged or obstructed.

The bore is free from obstruction.



The trigger units fitted to Accuracy International rifles are two stage triggers, they are designed and factory set as two stage triggers.

They must not be adjusted under any circumstances into a single stage trigger.

Failure to comply with this warning could result in possible missfires leading to danger to life and limb.

# Accuracy International Ltd.

**Warning!** - Before carrying out any trigger adjustments please ensure that all safety precautions have been observed.

## 2. Trigger weight adjustment (See Fig 3 & 4)

The trigger weight range of adjustment is 1.5Kg Min 2.0Kg Max; the trigger is factory set at 1.8Kg.

**Warning!** - Setting the trigger outside the limits stated below can compromise the safety and function of the trigger.

### Adjusting the trigger weight using a digital pull off gauge (Lyman 7832248)

The same procedure may be used utilising a force gauge or dead weight in accordance with the manufacturers instructions.

	<b>Warning!</b> - Ensure that the rifle is unloaded & safe to handle.
2.1	Place the rifle in the protected jaws of a bench vice, clamping just in front of the magazine housing. Alternatively place the rifle on a flat surface with the bipod attached.
2.2	Assemble the trigger roller to the gauge, once in the correct orientation use the locking nut to secure the roller into position.
2.3	Press the ready button to turn on the gauge, set the gauge to metric units by pressing the Lbs/Gm button.
2.4	Close the bolt & leave the safety in the fire position (ready to fire) see fig 2.
2.5	Holding the gauge parallel with the barrel, press the ready button, the gauge will bleep to indicate that it is set. Hook the trigger roller over the centre of the trigger shoe.
2.6	Pull the gauge backwards carefully keeping it parallel with the bore until the first stage is felt, then slowly increase pressure until the trigger is released.
2.7	Take care not to continue pulling once the trigger is released as this may cause errors in the reading.
2.8	The peak reading will be shown on the LCD screen of the gauge.
2.9	The reading should be taken several times and an average obtained.
2.10	The weight should be between 1.5kg and 2.0kg.
2.11	To INCREASE trigger weight, turn the weight adjustment screw clockwise half turn at a time using a 2mm hexagon key (See fig 3 & 4) weight will change by 1/4lb approx.
2.12	To DECREASE the trigger weight turn the weight adjustment screw anti-clockwise half turn at a time using a 2mm hexagon key. (See fig 3 & 4)
2.13	Retest the trigger weight several times between adjustments.
2.14	Do not exceed the minimum or maximum limits.

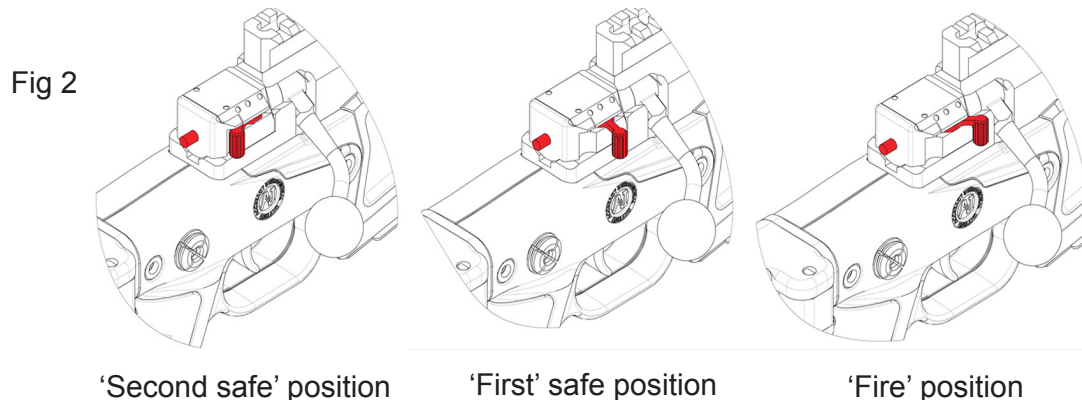
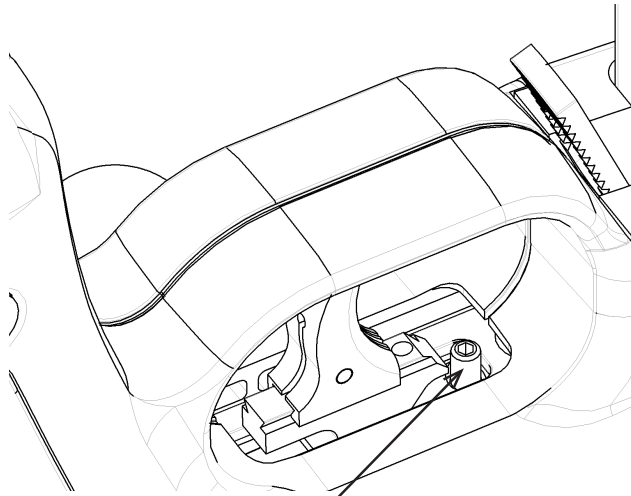
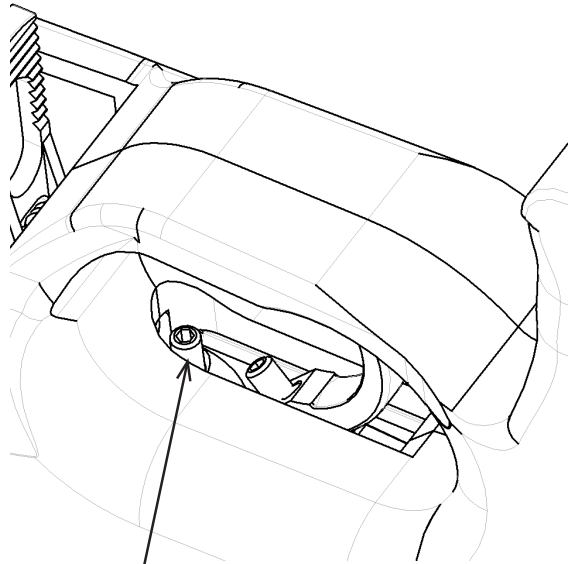

Fig 3



Trigger weight  
adjustment screw  
(AX/AT rifles)

Fig 4



Trigger weight  
adjustment screw  
(AW/AE rifles)

**Warning!** - If the trigger does not appear to be functioning safely and correctly within the stated trigger weight limits, please contact either Accuracy International Ltd or Accuracy International North America to arrange it's return.